

MPE

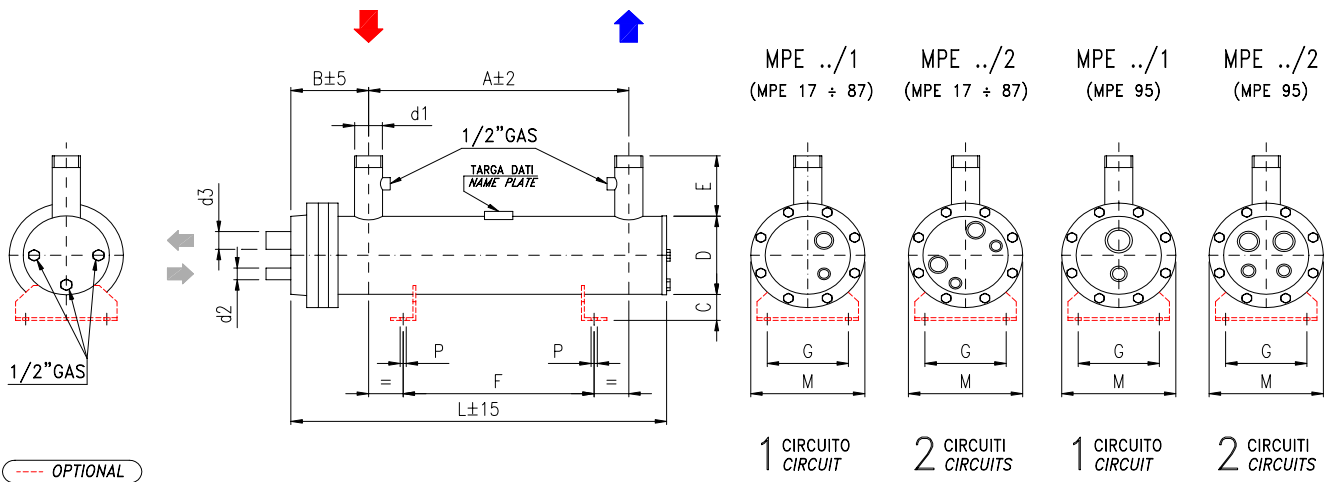

MODELLO / MODEL	MPE	17	26	35	45	55	70	87	95
Potenza totale	kW	17	26	35	45	55	70	87	95
Total capacity	Tons (RT)	4,8	7,4	10,0	12,8	15,6	19,9	24,7	27,0
Portata / Flow rate	m ³ /h	2,9	4,5	6,0	7,7	9,4	12,0	15,0	16,3
Perdite di carico / Pressure drop	kPa	9	24	31	25	20	27	22	24
Volume gas	L	3	4	5	5	7	9	10	10
Volume H ₂ O		8	9	11	12	15	16	19	21

Potenza totale = somma di tutti i circuiti / Total capacity = sum total of all circuits

DIMENSIONI DIMENSIONS (mm)	A	690	840	1040	1190	1030	1180	1380	1530	
	B	153						165		
	C	56						56		
	D	141						168		
	E	130						130		
	F	550	650	800	950	800	950	1100	1200	
	G	160						160		
	L	915	1065	1265	1415	1280	1430	1630	1780	
	M	225						225		
	P	12						12		

ATTACCHI / CONNECTIONS	ACQUA / WATER		d1 - PN 10	Ø 1-1/2"			Ø 2-1/2"		
	1 Circuito 1 Circuit	MPE../1	d2	ODS (RT) 22			ODS (RT) 22		
			d3	ODS (RT) 35			ODS (RT) 35		
	2 Circuiti 2 Circuits	MPE../2	d2	ODS (RT) 22			ODS (RT) 22		
			d3	ODS (RT) 35			ODS (RT) 35		

PESO / WEIGHT	kg	34	39	44	48	53	60	65	70
---------------	----	----	----	----	----	----	----	----	----

DATI NOMINALI NOMINAL DATA	R 407C	Temperatura entrata acqua / Inlet water temperature	+12°C	Temperatura di evaporazione / Evaporation temperature	+2.5 °C
		Temperatura uscita acqua / Outlet water temperature	+7°C	Temperatura di condensazione / Condensation temperature	+45 °C
		Fattore di sporcamento / Fouling factor	m ² /KW	0,000043	Surriscaldamento / Superheating



MPE

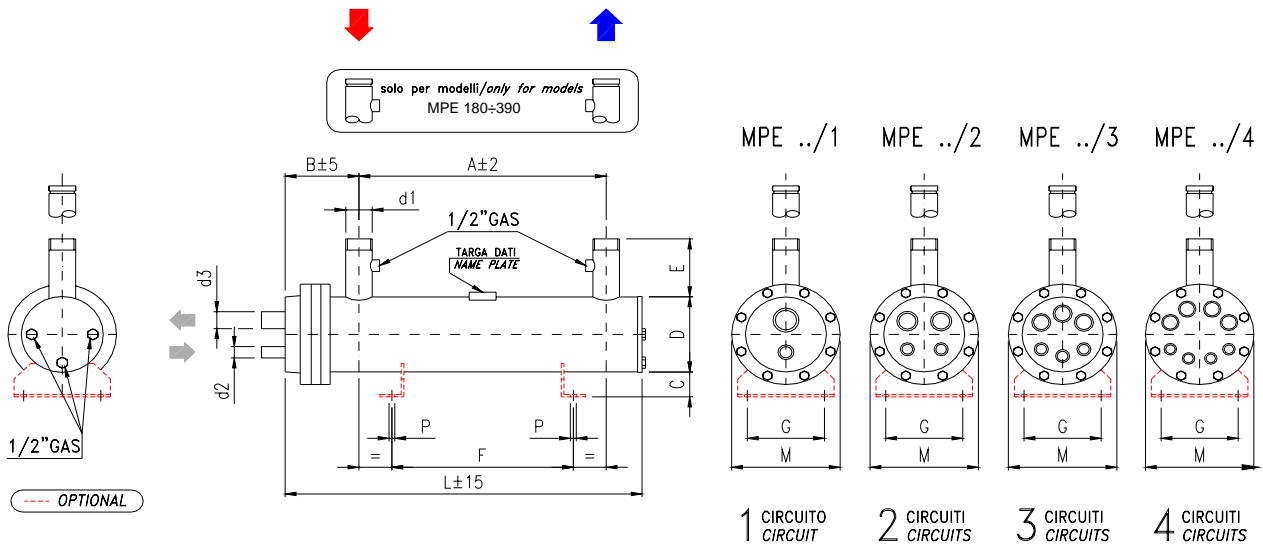

MODELLO / MODEL	MPE	121	137	160	180	230	300	335	390
Potenza totale	kW	121	137	160	180	280	300	335	390
Total capacity	Tons (RT)	34,4	39,0	45,5	51,2	79,6	85,3	95,3	110,9
Portata / Flow rate	m ³ /h	20,8	23,5	27,5	30,9	39,5	51,5	57,5	67,0
Perdite di carico / Pressure drop	kPa	23	25	30	20	27	42	47	49
Volume gas	L	13	15	17	19	22	30	34	41
Volume H ₂ O		30	35	37	51	55	105	99	90

Potenza totale = somma di tutti i circuiti / Total capacity = sum total of all circuits

DIMENSIONI DIMENSIONS (mm)	A	1530	1830	2030	2000	2300	2280	2280	2280	
	B	177			192			225		
	C	66			66			85		
	D	194			219			273		
	E	130			150			150		
	F	1200	1500	1700	1600	1800	1800	1800	1800	1800
	G	220			220			280		
	L	1805	2105	2305	2305	2605	2720	2720	2720	2720
	M	270			270			340		
	P	12			12			14		

ATTACCHI / CONNECTIONS	ACQUA / WATER		d1 - PN 10	Ø 3"	DN 100	DN 125
	1 Circuito 1 Circuit	MPE../1	d2	ODS (FL) 35	ODS (FL) 42	ODS (FL) 42
			d3	ODS (FL) 54	ODS (FL) 64	OD (FL) 89
	2 Circuiti 2 Circuits	MPE../2	d2	ODS (FL) 28	ODS (FL) 35	ODS (FL) 42
			d3	ODS (FL) 42	ODS (FL) 54	OD (FL) 76
	3 Circuiti 3 Circuits	MPE../3	d2	ODS 28	ODS 28	ODS (RT) 35
			d3	ODS 42	ODS 42	ODS (FL) 42
	4 Circuiti 4 Circuits	MPE../4	d2	ODS 22	ODS 22	ODS 28
d3			ODS 35	ODS 35	ODS 42	

PESO / WEIGHT	kg	95	104	112	127	145	210	215	230
---------------	----	----	-----	-----	-----	-----	-----	-----	-----

DATI NOMINALI NOMINAL DATA	R 407C	Temperatura entrata acqua / Inlet water temperature	+12°C	Temperatura di evaporazione / Evaporation temperature	+2.5 °C
		Temperatura uscita acqua / Outlet water temperature	+7°C	Temperatura di condensazione / Condensation temperature	+45 °C
		Fattore di sporamento / Fouling factor	m ² /KW	0,00043	Surriscaldamento / Superheating



Shell and tube evaporators

MPE

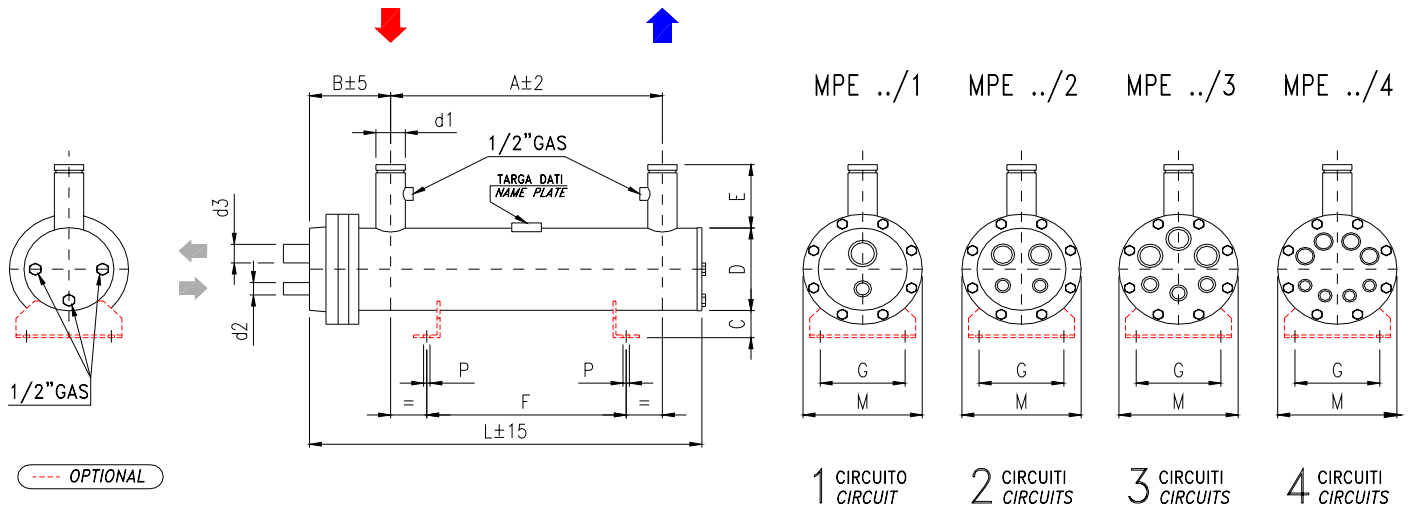

MODELLO / MODEL	MPE	460	510	570	650	750	820	880	975
Potenza totale	kW	460	510	570	650	750	820	880	975
Total capacity	Tons (RT)	130,8	145,0	162,1	184,8	213,2	233,2	250,2	277,2
Portata / Flow rate	m ³ /h	79,0	87,5	97,8	111,6	128,7	140,8	151,0	167,4
Perdite di carico / Pressure drop	kPa	41	46	62	52	62	43	46	91
Volume gas	L	45	52	61	69	80	95	102	118
Volume H ₂ O		143	134	121	230	216	196	240	210

Potenza totale = somma di tutti i circuiti / Total capacity = sum total of all circuits

DIMENSIONI DIMENSIONS (mm)	A	2250	2250	2250	2200	2200	2200	2500	2900	
	B	267			313					
	C	94			94					
	D	324			406					
	E	200			200					
	F	1800	1800	1800	1800	1800	1800	2000	2400	
	G	300			400					
	L	2760	2760	2760	2770	2770	2770	3005	3405	
	M	420			520					
P	16			16						

ATTACCHI / CONNECTIONS	ACQUA / WATER		d1 PN 10		DN 150		DN 200			
	1 Circuito 1 Circuit	MPE../1	d2 ODS	ODS (FL) 54		ODS (FL) 54		-		
			d3 OD	OD (FL) 114		OD (FL) 114		-		
	2 Circuiti 2 Circuits	MPE../2	d2 ODS	ODS (FL) 42		ODS (FL) 54		ODS (FL) 54		
			d3 OD	OD (FL) 89		OD (FL) 89		OD (FL) 89		
	3 Circuiti 3 Circuits	MPE../3	d2 ODS	ODS (RT) 35		ODS (FL) 42		ODS (FL) 42		
			d3	ODS (FL) 64		OD (FL) 89		OD (FL) 89		
	4 Circuiti 4 Circuits	MPE../4	d2 ODS	ODS 35		ODS (FL) 42		ODS (FL) 42		
d3			ODS 54		OD (FL) 76		OD (FL) 76			

PESO / WEIGHT	kg	340	350	360	540	553	580	610	670
---------------	----	-----	-----	-----	-----	-----	-----	-----	-----

DATI NOMINALI NOMINAL DATA	R 407C	Temperatura entrata acqua / Inlet water temperature	+12°C	Temperatura di evaporazione / Evaporation temperature	+2.5 °C
		Temperatura uscita acqua / Outlet water temperature	+7°C	Temperatura di condensazione / Condensation temperature	+45 °C
		Fattore di sporcamento / Fouling factor	m ² /KW	0,000043	Surriscaldamento / Superheating



MPE

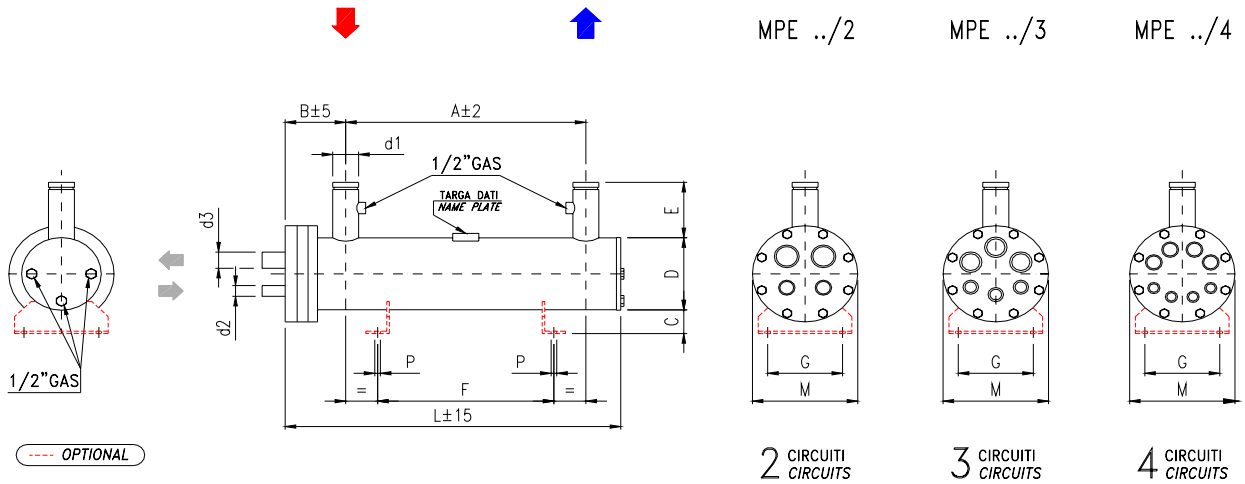

MODELLO / MODEL	MPE	1035	1110	1260	1350				
Potenza totale	kW	1034	1110	1258	1348				
Total capacity	Tons (RT)	294,0	315,6	357,7	383,3				
Portata / Flow rate	m ³ /h	177,5	190,5	215,9	231,4				
Perdite di carico / Pressure drop	kPa	47	46	61	59				
Volume gas	L	129	147	156	183				
Volume H ₂ O		298	285	438	420				

Potenza totale = somma di tutti i circuiti / Total capacity = sum total of all circuits

DIMENSIONI DIMENSIONS (mm)	A	2900	2900						
	B	322	340						
	C	94	94						
	D	457	508						
	E	200	200						
	F	2400	2400						
	G	400	400						
	L	3420	3445						
	M	570	620						
	P	16	18						

ATTACCHI / CONNECTIONS	ACQUA / WATER		d1 PN 10	DN 200	DN 200					
	2 Circuiti 2 Circuits	MPE../2	d2	ODS (FL) 54	OD (FL) 76					
			d3	OD (FL) 114	OD (FL) 141					
	3 Circuiti 3 Circuits	MPE../3	d2	ODS (FL) 42	ODS (FL) 54					
			d3	OD (FL) 89	OD (FL) 114					
	4 Circuiti 4 Circuits	MPE../4	d2	ODS (FL) 42	ODS (FL) 42					
d3			OD (FL) 76	OD (FL) 89						

PESO / WEIGHT	kg	830	871	1035	1090				
---------------	----	-----	-----	------	------	--	--	--	--

DATI NOMINALI NOMINAL DATA	R 407C	Temperatura entrata acqua / Inlet water temperature	+12°C	Temperatura di evaporazione / Evaporation temperature	+2.5 °C
		Temperatura uscita acqua / Outlet water temperature	+7°C	Temperatura di condensazione / Condensation temperature	+45 °C
		Fattore di sporco / Fouling factor	m ² /kW	0,000043	Surriscaldamento / Superheating

